

## **NOTICE INVITING TENDER FOR CETP**

Sealed tenders are hereby invited by the Chairman M/s Sirmour Green Environ Ltd, C/o Plot No. 50, I.A. Gondpur, Paonta Sahib Distt Sirmour H.P. in two covers on lum-sum basis for under mentioned works from the First Class Contractors/Firms enlisted with the State/ Centre Govt. who must have experience of construction of at least 1 MLD CETP or STP during last Five years.

<b>Sr. No.</b>	<b>Description</b>	<b>E/cost</b>	<b>E/money</b>	<b>Comp. Time</b>	<b>Cost of Form</b>
1	Providing Common Effluent Treatment Plant of 2.00 MLD CETP Unit in Industrial Area Gondpur, Paonta Sahib Distt Sirmour H.P. (Including Installation and commissioning based on MBBR Technology with O&M for 12 Months.	Rs. 8.47 Cr.	Rs. 10.00 Lakhs	Within 6 months	Rs. 2500/-

**Key dates will be as under;**

1	Date of Sale of tender form	04-11-2020 to 15-11-2020
2	Site visit/ consideration of queries through e-mails	Upto 20-11-2020
3	Date of submission of tender/documents:- cover -1 (Technical bid) and cover-2 (Financial bid) separately	25-11-2020 upto 5 PM
4	Date of opening of tender document (Cover-1)	26-11-2020 at 11 AM
5	Date of opening of tender document (Cover-2)	27-11-2020 at 11 AM

**Note:** For detailed terms and conditions, eligibility criteria and scope of work please visit our website: [www.sirmourgreen.com](http://www.sirmourgreen.com)

Director,

M/s Sirmour Green Environ Ltd  
Paonta Sahib, Distt. Sirmour H.P.

**AVAILABILITY OF FORMS: -**

Tender documents consisting of the Scope of Work, Technical Details, Detailed Plan and Specifications etc. and the set of conditions to be complied can be downloaded from the website [www.sirmourgreen.com](http://www.sirmourgreen.com) or it can be had from the office of Director SGEL, 50,IA Gondpur, District Sirmour, H.P. and **the cost of forms can be deposited through Demand Draft** with the bid on or before prescribed date.

**GENERAL INFORMATION:**

- 1) **Industrial effluent volume is estimated at 1.50MLD and Sewage effluent at 0.5 MLD thus total capacity is SGEL.0 MLD.**
- 2) **At present there are about 46 member units mostly being pharma units.**
- 3) **Number of Industries may increase or decrease in future but total volume of Effluents shall be within 2.0 MLD during O&M period i.e. at least for one year.**
- 4) **90% of member Industries are located in a radius of 2 KM Appx. Few Industries are located on the outskirts of Industrial Area Gondpur.**
- 5) **Sewage effluent shall be brought upto CETP site through separate pipe line already existing, Connection work and minor networking would be required**
- 6) **Industrial effluents shall be brought through Pipe line and this network will be provided by the Contractor concerned. For outside Industries, one or two tankers shall be arranged by SPV itself and it is not in the scope of above NIT.**
- 7) **Contractor shall borne all the expenses including diesel and electricity during O& M period of 12 months.**
- 8) **The inlet standards to the CETP have been notified by HPPCB and in case exceeding the limit in primary standards at Industry level, the same shall attract provisions u/s 33,33-A and 41of the water (prevention and control) Act 1974.**
- 9) **At outlet of CETP, the discharge standards prescribed by MoEF & CC GoI vide Notification no. SO4(E)dated 01-01-2016 shall be applicable.**
- 10) **After treatment, water will be discharged into adjoining Nallah, however, contractor may submit proposal for better use of water i.e. for Industries/ Irrigation etc.**
- 11) **For sludge disposal, Contractor may identify Govt approved disposal site at his own, however, Shivalik Solid Waste Management Site Nalagarh Distt. Solan is designated site of HP.**
- 12) **Bidders are allowed to offer bids over and above the estimated cost, however, Committee will approve lowest value bid who fulfil other technical criteria.**
- 13) **Contractor will bear entire development cost of land/site including 50 mtrs long RCC protection wall towards Nallah.**
- 14) **SEGL will provide Electrical Connection only and rest of the infrastructure expenses including DG Set will be borne by the Contractor.**
- 15) **Successful bidder will have to get the structural designs vetted from IIT Roorkee or any other IIT/NIT.**
- 16) **It is a time bound project to be completed within 6 months from the date of award. There will be late penalty @ Rs. 10000/- per day (Max Rs. 15 lakhs), however, performance reward @ Rs. 10000/- per day (Max Rs. 15 Lakh) will be given in case project is completed before prescribed time.**
- 17) **Payments will be made to the Contractor as quickly as possible depending upon the progress and quality of work.**
- 18) **The site is readily available with SGEL and it shall be made available to the Contractor as soon as the work is awarded.**

## **FILLING, SUBMISSION & OPENING OF TENDER DOCUMENTS: - (Standard Conditions)**

1. Tenders will be received by the authority up to date & time given **in NIT**.
2. Canvassing / compartmentalization is strictly prohibited and the tenders submitted by the contractors who resort to same shall be liable for rejection.
3. The contractors **must quote the rates in figures as well as in words**. The requisite bid be given in sum-sump.
4. Tender containing doubtful figures shall be rejected.
5. The contractor should read the specifications carefully before submitting the tender.
6. If it is found that the tender is not submitted in proper manner or contains too many corrections or absurd rates or amounts it would be open for SGEL to take suitable action against him.
7. The acceptance of a tender after opening will rest with the Chairman, SEGL or any other person authorized by the SGEL, who does not bind himself to accept the lowest tender and reserves to himself the right to reject any or all of the tenders received without assigning any reason. All tenders in which any of the prescribed conditions are not fulfilled or are incomplete in any respect are liable to be rejected.
8. The contractor should also see all drawings and in case of doubt, obtain required clarifications which may in any way influence his tender as no claim whatsoever shall be entertained for any alleged ignorance thereof, once tender has been opened.
9. If on check, there are differences between the rates quoted by the contractor in words and in figures or in the amount worked out by him, the following procedure shall be followed:
  - a. *When there is a difference between the rates in figures and in words, the rates, which correspond to the amounts worked out by the contractor, shall be taken as correct.*
  - b. *When the amount of an item is not worked out by the contractor or it does not correspond with the rates written either in figures or in words, then the rate quoted by the contractor in words shall be taken as correct.*
  - c. *When the rate quoted by the contractor in figures and in words tally but the amount is not worked out correctly the rate quoted by the contractor shall be taken as correct and not the amount.*
10. It is in the interest of the contractor to visit the site of work and acquaints himself with conditions prevalent there before submitting his tender. As no claim whatsoever shall be entertained once tender has been submitted.
11. The time allowed for completion of the work shall be 6 months extendable to further 3 months under compelling circumstances and it shall be reckoned from the fifteenth day after the date of written orders to commence the work, by the engineer in charge.
12. All statutory deductions such as GST/Income tax/ labour cess or any other statutory levies as levied by Government of Himachal Pradesh or Govt. of India from time to time shall be payable and deducted from the bills of contractor at the prescribed rates and Govt. will not entertain any claim whatsoever on this account.
13. If the bid of the successful Bidder is seriously unbalanced in relation to the SGEL Engineer's estimate of the cost of work to be performed under the control, the Engineer-in-charge may require the Bidder to produce detailed price analysis for any or all items of the bill of Quantities to demonstrate the internal consistency of those prices with the construction methods and schedule proposed. After evaluation of the price analysis, the Engineer-in Charge require that the amount of the Security deposit be increased to a level sufficient to protect the employer against financial loss in the event of default of the successful Bidder under the contract.

### **EARNEST MONEY: -**

14. Earnest money shown above must be deposited in the shape of Fixed Deposit Receipts of a Nationalized bank duly pledged in the name of “Director, M/s Sirmour Green Environ Ltd.”.
15. The tenders of those contractors who do not deposit the Earnest Money in the prescribed manner will not be opened and summarily rejected.
16. In cases where a tenderer was lowest or other than the lowest & whose offer has been accepted, either withdraws the offer or fails to commence the work, the earnest money so deposited by the tenderer shall stand forfeited.

### **SECURITY DEPOSIT: -**

17. The contractor whose tender is accepted, (unless exempted) will be required to furnish by way of security deposit for the due fulfillment of his contract @ Rs. 15.00 lakhs in the shape of Fixed deposit receipt in any schedule bank in HP duly pledged in favour of “Sirmour Green Environ Ltd”. The earnest money shall however be adjusted against the security deposit. The security deposit will be refundable only at the end of the O & M period of 12 months.

### **Tender Documents**

#### **1. The tender documents shall be submitted in SGEL (two) covers:-**

- (a) **Cover-1** shall contain “Technical Bid”. It shall contain
  - Work done/ Experience Certificates as per Pre-qualification criteria
  - Contractor will submit Process design with size of Units/Components alongwith Data sheet of proposed CETP. Demand draft of Tender Form for Rs. 2500/-
  - Income tax returns of last three Assessment years
  - Copy of Certificate of registration with I&PH Department or any other State/Central Govt. Department or Govt. Undertakings (1<sup>st</sup> Class).
  - Undertaking that I/we have carefully studied all the terms and conditions stipulated in the contract document before quoting the rates.
  - Copy of Certificate of EPF registration.
  - Copy of Certificate of ESIC registration.
- (b) **Cover-2 shall contain “Financial Bid”** which shall be opened only of those bidders /Firms whose documents as per “Eligibility Criteria” / “Technical Bid” Information is found in order.
  - . It shall contain-
  - Prescribed Tender Form with Annexure I in which bid value is quoted.

➤ **Pre-qualification criteria proof:-**(a) A bidder/firm shall be considered pre-qualified for the work if he has:-

- i. Average Annual financial turnover during the last 3 years, ending 31st March of the previous financial year, at least Rs. 4.0 Cr.
- ii. Experience of having successfully completed similar works during last 7 years ending last day of month previous to the one in which applications are invited should be either of the following: -
  - a. Three similar completed works costing not less than the amount equal to Rs. 2.50 Cr.  
or
  - b. Two similar completed works costing not less than the amount equal to 3.50 Cr.  
or
  - c. One similar completed work costing not less than the amount equal to Rs. 4 Cr.

**Similar nature of work:**

- *Bidder must have completed at least one work of capacity 1 MLD CETP earlier on MBBR or any advance technology.*

## Tender General Conditions

- Joint venture is not allowed.
- Copy of PAN (Permanent Account No.), GST registration.
- The Lowest successful firm/contractor participating in the tendering process shall be registered under EPF/ESIC failing which this work shall not be awarded to it/him.
- Rates quoted must be in INR (Indian Rupee) and shall be inclusive of all taxes applicable at the time of opening of bids.
- Lowest Bid security of L1, L2 and L3 shall be retained till the finalization of the offer of the lowest bidder or 60 days whichever is earlier.
- No subletting of work as a whole by the bidder is permissible.
- In case, opening day is a holiday, the bids shall be opened on next working day at the same time.
- The offer of the tender shall remain valid for the 60 days after the opening of tender (Financial Bid).
- Ambiguous/telegraphic/ Conditional bids or bids by Fax/E-mail shall not be entertained/ considered in any case.
- Conditional bids are liable to be rejected without assigning any reasons.
- SGEL reserves the right to reject/cancel any or all the /bids without assigning any reason(s).
- Rates should be quoted both in figure as well as in words in Indian Rupee (INR).

The time allowed for completion of the work shall be 6 months extendable to further 3 months under compelling circumstances and it shall be reckoned from the fifteenth day after the date of written orders to commence the work, by the engineer in charge.

All statutory deductions such as GST/Income tax/ labour cess or any other statutory levies as levied by Government of Himachal Pradesh or Govt. of India from time to time shall be payable and deducted from the bills of contractor at the prescribed rates and Govt. will not entertain any claim whatsoever on this account.

If the bid of the successful Bidder is seriously unbalanced in relation to the SGEL Engineer's estimate of the cost of work to be performed under the control, the Engineer-in-charge may require the Bidder to produce detailed price analysis for any or all items of the bill of Quantities to demonstrate the internal consistency of those prices with the construction methods and schedule proposed. After evaluation of the price analysis, the Engineer-in Charge require that the amount of the Security deposit be increased the expenses of the successful bidder to a level sufficient to protect the employer against financial loss in the event of default of the successful Bidder under the contract.

MD-cum-Chairman, SEGL,  
Plot No. 50, I.A. Gondpur, Paonta Sahib  
District Sirmour, H.P.

# TENDER FORM

To

The Chairman,  
Sirmour Green Environ Ltd  
50, I.A. Gondpur, Distt Sirmaur, H.P.

Sir,

1. I/We have read and examined the following terms & conditions and related documents to the tender:-
  - A. General information, Standard conditions, tender Documents & General Conditions of contract along with Annexure 1; and
  - B. Scope of Work, Technical Details, Detailed Plan and Specifications.
2. I/We here by tender for the execution of the works referred to in the aforesaid documents upon the terms and conditions contained or referred to therein and in accordance in all respects with the specifications, designs, drawings and other relevant details, as may be fixed under the terms and conditions of the contract and within the period of completion as stipulated in the tender documents.
3. In consideration on me/us being invited to tender, I/We agree to keep the tender open for acceptance for a period of 60 days –General Conditions of Tender Notice.
4. A sum of Rs. \_\_\_\_\_ /- (Rupees \_\_\_\_\_) is hereby forwarded in the form of Fixed Deposit Receipts of any Nationalized Bank as Earnest Money vide NIT.  
If I/We –
  - i) fail to keep the tender open as aforesaid, or
  - ii) after the tender is accepted, fail to commence the execution of the works as provided in the condition.I/We agree that the SGEL shall, without prejudice to any other right or remedy, be at liberty to forfeit the said earnest money absolutely.
5. If my/our tender is accepted.  
I/We,-
  - i) agree to abide by and fulfils all the terms, conditions and provisions of the aforesaid documents;
  - ii) undertake to commence the work soon after the date of issue of the written order of the SGEL's Engineer-in- charge and to complete and deliver the whole of the work comprised in the contract within six months from the fifteenth day after the date on which the Engineer-in-charge issues written orders to commence the work'
  - iii) agree that the amount of earnest money shall be appropriated towards the security deposit; and
  - iv) undertake to furnish, within 21 days of the date of issue of the letter of acceptance by the Accepting Authority, the balance amount of security deposit as per the standard conditions after Award of Work.

Stamped signature of the tenderer  
or his Authorised Representative

**QUOTATION LETTER**

Name of the Contractor:\_\_\_\_\_

Address of the Contractor:\_\_\_\_\_

Contact Details (email id, Phone No.):\_\_\_\_\_

PAN/GSTIN:\_\_\_\_\_

Name of the tender:\_\_\_\_\_

Cost of the Tender (Rs.):\_\_\_\_\_

Cost of the Tender (In words):\_\_\_\_\_

**Scope of Work: Providing common effluent Treatment plant of 2.00 MLD CETP Unit in Industrial Area Gondpur, Paonta Sahib Distt Sirmour H.P. (Including Installation and commissioning based on MBBR Technology completely and operation and maintenance of complete system (CETP) for 12 Months after stabilization of Plant at Paonta Sahib.)**

I/We.....( name of the tenderer)  
undertake(s) to construct the above mentioned project as the layout and plan at various sites of the project on the cost of Rs.\_\_\_\_\_,  
(Rupees)\_\_\_\_\_ only in Indian Rupees subject to the stipulations made in the accompanying tender documents.

Signature of the tenderer or his  
Authorized representative

**Notes for tenderer's:-**

- i) The amount to be given in the above letter, should be rounded off to the nearest thousand rupees.
- ii) special care should be taken to give the amount in such a way that manipulation is not possible



## Technical Details

### DETAILED DESCRIPTION OF CIVIL TANKS & OTHER CIVIL CONSTRUCTION

No	Description of Tank	Size	Const.
<b>AT PLOT NO 96-97.</b>			
1	Bar Screen Chamber	6 X 3 X 1.5	RCC
2	Oil Trapping tank	13.5 X 4 X 5.5	RCC
3	Trapped Oil Sump	2 X 2 X 2.5	RCC
4	Parshell flow tunnel	4 X 3 X 2.5	RCC
5	Equalization tank	10.5 X 8 X 7.5	RCC
6	Chemical Mixer tank	Dia 2 X 3.6	RCC
7	Flocculator Tank	Dia 4 X 4.1	RCC
8	Primary Settling tank	Dia 10 X 3.6	RCC
9	UASB Reactor	Dia 15 X 5.6	RCC
10	MBBR Reactor tank	14 X 8 X 5.5	RCC
11	Air Polishing tank	14 X 8 X 5.5	RCC
12	Secondary Settling tank	Dia 10 X 3.6	RCC
13	Treated water tank	8 X 5 X 5.3	RCC
14	Sludge Thickner	Dia 4 X 3.4	RCC
15	Sludge Storage yard	6 X 5 X 3	BRC
16	Chemical Store	6 X 5 X 3	BRC
17	Blower room cum Work shop	5 X 4.5 X 3.5	BRC
18	Control panel room	5 X 3 X 3.5	BRC
19	All internal Drains	As per drg.	BRC
20	Land development & Boundary	As per drg.	BRC
	Other Miscellaneous work	As per drg.	
<b>AT OTHER PLOT :</b>			
1	Administrative Building	6 X 5 X 3	BRC
2	Laboratory	9 X 6 X 3	BRC
3	Chemical Store	9 X 5 X 3.5	BRC
4	Record room	5 X 5 X 3.5	BRC
5	Utility Block	2.8 X 2.5 X 3.5	BRC
6	Green Field Area Development	2000 Sq.Mt.	
	Land development & Boundary	As per drg.	BRC

**DETAILED DESCRIPTION & COST OF E & M MACHINERIES**

No	Item Description	Unit	Qty
1	Bar Screening system comprising of Dampers, Screens (Auto & Manual), Conveyors', Trolley as per details mentioned in list	System	1
2	Trapped Oil transferring tunnel with drive	Unit	1
3	Online liquid flow meter for open channel	Nos.	1
4	Turbulence Grid in u PVC	Nos.	1
5	Effluent transfer pump Self Priming 7.5 KW	Nos.	2
6	Mixing assembly for Civil const. Chemical Mixer	Nos.	1
7	Mixing assembly for Civil const. Flocculator	Nos.	1
8	Chemical dosing unit with a tank & 2 dosing pump	Nos.	6
9	Mechanical Scrapper for Civil constructed PST all wetted part in SS 316 with drive unit	Unit	1
10	Bottom distribution grid in uPVC for UASB reactor	Nos.	1
11	Media For Civil constructed UASB Reactor	CuM	120
12	Circulation cum feed pump for UASB reactor	Set	2
13	Bio-Gas Flaring system of 5kg/Hr with blower	Set	1
14	Aeration grid for MBBR reactor Tank	Nos.	1
15	Bio-Pack Media For Civil constructed MBBR Reactor	CuM	150
16	Aeration grid for Air Polishing tank	Nos.	1
17	Twin Lobe Air Blower with drive motor of 11.2 KW	Set	2
18	Mechanical Scrapper for Civil constructed SST all wetted part in SS 316 with drive unit	Unit	1
19	Bio-active sludge recirculation pump	Set	2
20	Online chemical dosing units for sludge conditioning	Unit	2
21	Mechanical Scrapper for Civil constructed Sludge conditioning tank all wetted part in SS 316 with drive unit	Unit	1
22	Sludge feed pump screw type for filter press with drive motor	Set	2
23	Filter press of 18" X 18" X 23 Plates in PP Construction with hydraulic unit	Nos.	2
24	Pressure pump for tertiary treatment unit	Set	3
25	Pressure sand filter unit with network & Media	Nos.	2
26	Activated carbon Filter with network & Media	Nos.	2
27	Pre Filter unit feed pumps	Set	3
28	Pe Filter unit Block of 25 KLH rating	Unit	6
29	Pipeline, valves, fittings as per layout	Lot	1
30	Instrument of control & monitoring of process	Lot	1
31	Control panel and cabling & earthing of the equipment's	Lot	1
32	Transformer and associated electrical installation	Unit	1
33	DG Sets of 80 KVA in case for power supply in case of power cut	Set	1
34	Laboratory instruments, chemicals and accessories	Unit	1
35	Online monitoring system for outlet parameters as per guidelines of CPCB	Unit	1
36	Workshop machineries	Lot	1

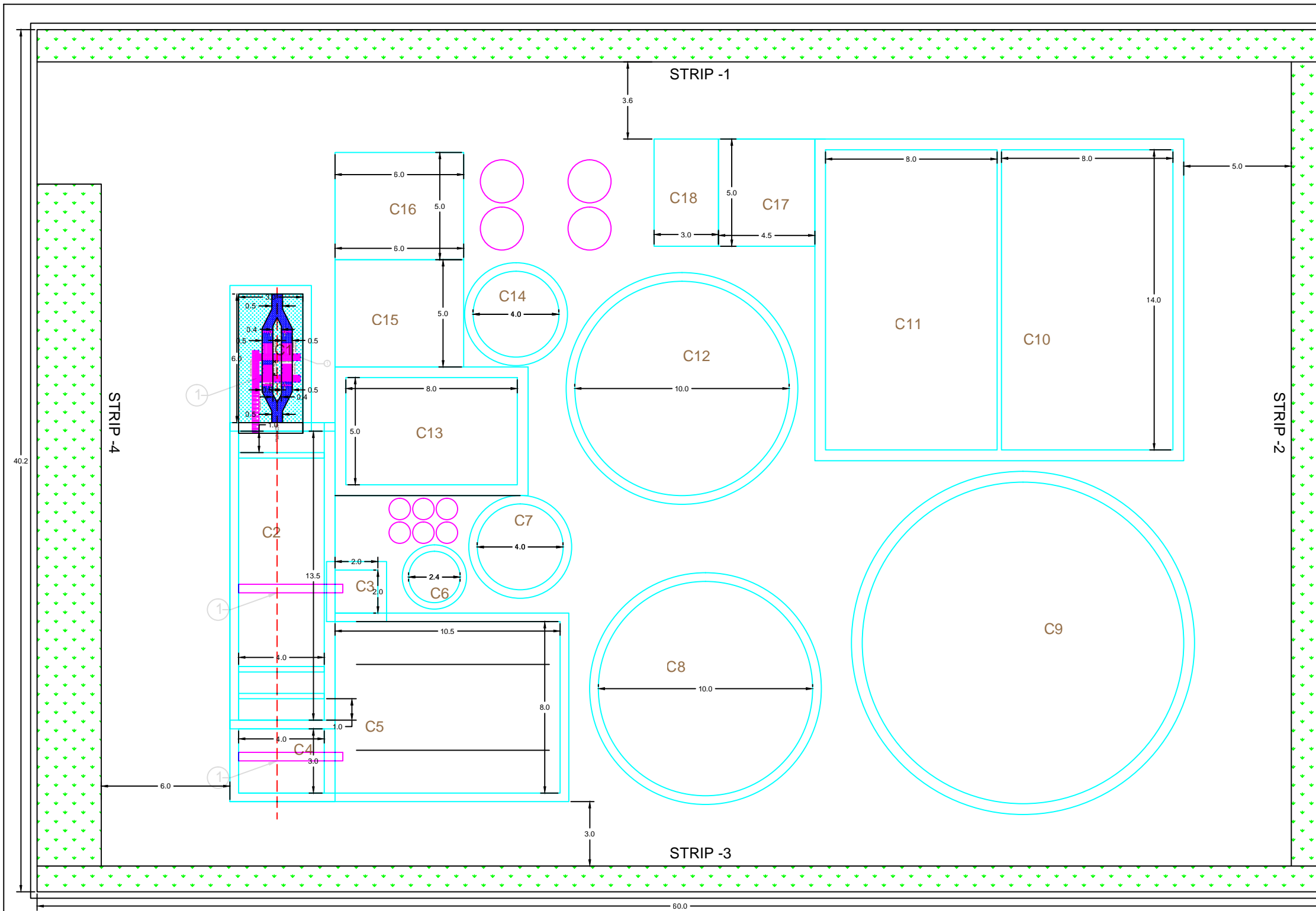

Not.	Description	SIZE/CAPACITY	QTY	Unit
1	Bar Screen System	250 KLH; For 500 mm open Drain	1	Unit
2	Trapped Oil Transfer Tunnel	250 KLH	1	No
3	In line Flow Meter (Non Contact)	4X3X0.5+1.5(IL)	1	No
4	Turbulence Grid (Equalisation tank)	10.5X8X6+1.5IL	1	Unit
5	Effluent Transfer Pumps	100 KLH; 12 M	2	Set
6	Mixing Assembly for Chemical Mixer	Dia 2.4 X 2.0+0.5FB	1	Unit
7	Mixing Assembly for Flocculator	Dia 4 X 4.0+0.6FB	1	Unit
8	Chemical Dosing Units	0-50 LPH	6	Unit
9	Mechanical Scraper For PST	Dia10 X 2.5+0.5 Cone +0.6FB	1	Unit
10	Bottom Distribution Grid For UASB Reactor	For Civil constructed UASB reactor	1	Unit
11	Media for UASB reactor	120 Cu. M	1	Lot
12	Circulation Pump for UASB reactor	300 CMH; 10 M	2	Sets
13	Bio-Gas Flaring System	5 Kgs/ Hr.	1	Set
14	Aeration Grid For MBBR tank	14X 8 M Tank	1	Unit
15	BIO-PACK Media For MBBR tank	uPVC Circular	40	Cu.M
16	Aeration Grid For Air Polishing tank	14X 8 M Tank	1	Unit
17	Twin Lobe Blower	11.2 KW	2	Sets
18	Mechanical Scraper For SST	Dia10 X 2.5+0.5 Cone +0.6FB	1	Unit
19	Bio-Active Sludge Re-circulation pump	12 KLH; 10 M; 1HP	2	Sets
20	On line Chemical Dosing system OF SCC	0 - 10 LPH	2	Unit
21	Mechanical Scraper For Sludge Thickener	Dia4 X 2.5+0.3 Cone +0.6FB	1	Unit
22	Sludge Feed Pump	5 KLH; 35 M	2	Sets
23	Filter Press	24' X 24'; 35 Plates	2	Nos.
24	Pressure Pump for feed to tertiary unit	50 KLH; 30 M	3	Sets
25	Pressure Sand Filter	50 KLH	2	No.
26	Activated Carbon Filter	50 KLH	2	No.
27	Pre Filter Feed Pump	50 KLH	3	Sets
28	Pre Filter Unit	25 KLH	6	Nos.

Not.	Description	SIZE	MOC
C1	Bar Screen Chamber	6X3X0.5+1(IL)	RCC
C2	Oil trap	13.5X4X4+1.5(IL)	RCC
C3	Trapped Oil Sump	2 X 2 X 1+1.5(IL)	RCC
C4	Parshell flow tunnel	4X3X0.5+1.5(IL)	RCC
C5	Equalisation tank	10.5X8X6+1.5IL	RCC
C6	Chemical Mixer	Dia 2 X 3+0.6FB	RCC
C7	Flocculator	Dia 4 X 3.5+0.6FB	RCC
C8	Primary Settling tank	Dia10 X 2.5+0.5 Cone +0.6FB	RCC
C9	UASB Reactor	Dia15 X 5+0.6FB	RCC
C10	MBBR Reactor tank	14X 8 X 5+0.5FB	RCC
C11	Air Polishing tank	14X 8 X 5+0.5FB	RCC
C12	Secondary clarifier	Dia10 X 2.5+0.5 Cone +0.6FB	RCC
C13	Treated water tank	8X5X5+0.3FB	RCC
C14	Sludge Thickner	Dia4 X 2.5+0.3 Cone +0.6FB	RCC
C15	Sludge Storage yard	6 X 5 X 3	BRC
C16	Chemical store	6 X 5 X 3	BRC
C17	Blower room Cum Work shop	5 X 4.5 X 3.5	BRC
C18	Control panel room	5 X 3 X 3.5	BRC
	Internal Drains	As required	BRC

No. of Plots : 02 Nos.  
 PLOT AREA = 2 X 30 X 40.2 = 2412 M<sup>2</sup>.  
 Constructed Area & Road = 1790 M<sup>2</sup>  
 Un covered area = 306.25 M<sup>2</sup>  
 Area of Green Field = 312.75 M<sup>2</sup>

STRIP	SIZE M	Area Sq.M
1	60 X 1.5	90.00
2	37.5 X 1.5	56.25
3	60 X 1.2	72.00
4	31.5 X 3	94.50
<b>5</b>	<b>TOTAL GREEN FIELD</b>	<b>312.75</b>

CLIENT :	SIRMOUR GREEN ENVIRON LTD., NIHALGARH, POANTA SAHIB, (H.P.)
DEPARTMENT :	DIC, DISTRICT SIRMOUR GOVT. OF HIMACHAL,
CONSULTANT :	ENVIRO TECHNOLOGY LTD., ANKLESHWAR, GUJRAT
PROJECT :	CETP OF GONDPUR I. A., POANTA SAHIB
TITLE :	PLAN LAYOUT OF 2 MLD CETP
DRG. NO.	CETP-PON./2MLD/002
Date	8/12/18
Drw By	CHKD By
App. By	